

## Scopecoat™

The Devtron **Scopecoat™** is constructed of the highest quality neoprene (2, 3, 5 and 6mm thick) laminated with nylon. Its simple design safeguards any kind of scope from dings and scratches, dust, dirt, and moisture. The shock and moisture absorbing Neoprene helps draw moisture and condensation away from your scope and helps protect it from the elements.

**Scopecoat™** stretches approximately 10% and the correct fit is either relaxed or snug. **Scopecoat™** fits a variety of scopes and when choosing the right size **Scopecoat™**, measure your scopes overall length in inches and the objective in millimeters.



## XP-6 Flak Jacket

**=XP-6=**  
*Flak Jacket*

### See why we call it the Flak Jacket!

The XP-6 Flak Jacket is 6mm thick - that's three times thicker than our standard 2mm **Scopecoat™**. We talked with law enforcement and military agencies and developed what we believe is the ultimate protection.



[larger view](#)

Law enforcement agencies both domestic and abroad have chosen **Scopecoat™** to protect their optics.

The **Scopecoat™** XP-6 Flak Jacket fits scopes for law enforcement (SWATT), Bench Rest, Varmint, Leupold™ and Sniper scopes, as well as all tactical weapons including pistol, electronic, aim point, pro point, and the Bushnell HOLOSight.



[larger view](#)

For those with tall turret scopes, we haven't left you out. Our XP-6 Flak Jackets are specially designed for tall turrets including the new Leupold Mark 4 Sniper scope, and Night Force NSX and Benchrest models with sizes that accommodate two or three tall turret adjustment knobs.

The XP-6 Flak Jacket™ is specifically designed for extra protection and special applications. Because of the superior protection it offers, law enforcement agencies everywhere choose this **Scopecoat™** to protect their precision optics.

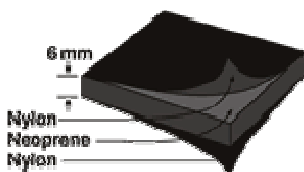

**=XP-6=**  
*Flak Jacket*

## Scopecoat™ Sizes - choose the correct size for your scope

You will need a ruler or measuring tape to get started.



To figure out what size **Scopecoat™** you will need for cylindrical type scopes follow the steps below and view the diagrams.

### STANDARD RIFLE SCOPES

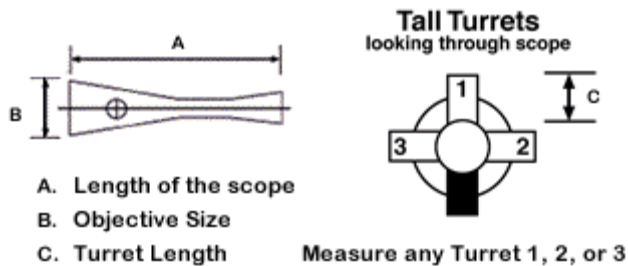

1. Measure the overall length of the scope. Include sunshade if applicable.
2. Measure the objective size. (The objective end of the scope is the end you do NOT look through while in use.)
3. Measure the turrets. These are the adjustment knobs on the scope. If the turrets are **3/4 inches or more, they are considered "Tall Turrets"** and you would need the XP6 Flak Jacket model **Scopecoat™**.

\*Note - our **Scopecoat™** cylindrical covers stretch 1 to 1 1/2 inches past the actual size. For example, a 10.5 inch cover can stretch to 12 inches. With this in mind, select the right size for a relaxed or snug fit.

With your measurements, Quick Reference **Scopecoat™** sizes and types for standard cylinder shaped optics. Below

### QUICK REFERENCE - Standard Cylindrical Scopes

With your measurements, Scope Length X Objective Size, select your size and type of **Scopecoat™**.

\*Note - our **Scopecoat™** cylindrical covers stretch 1 to 1 1/2 inches past the actual size. For example, a 10.5 inch cover can stretch to 12 inches. With this in mind, select the right size for a relaxed or snug fit.

Standard Rifle Scopes

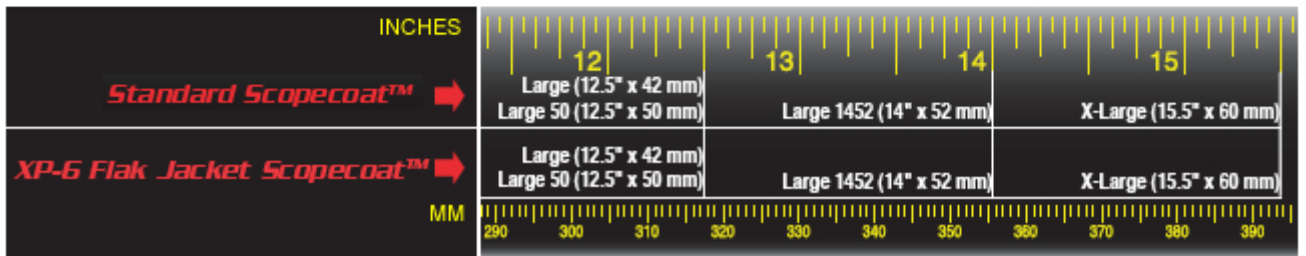
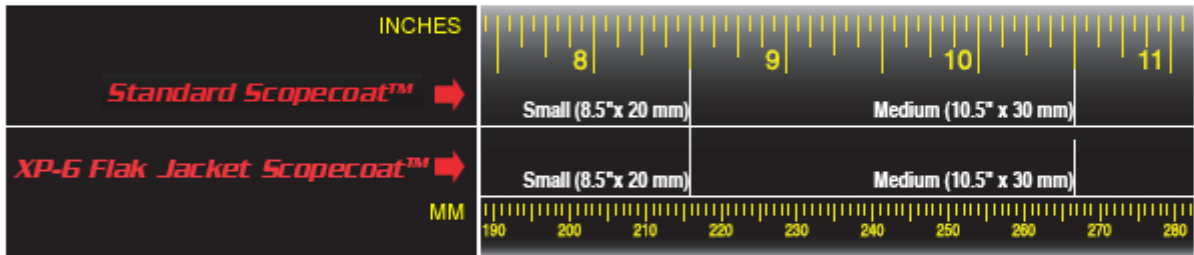
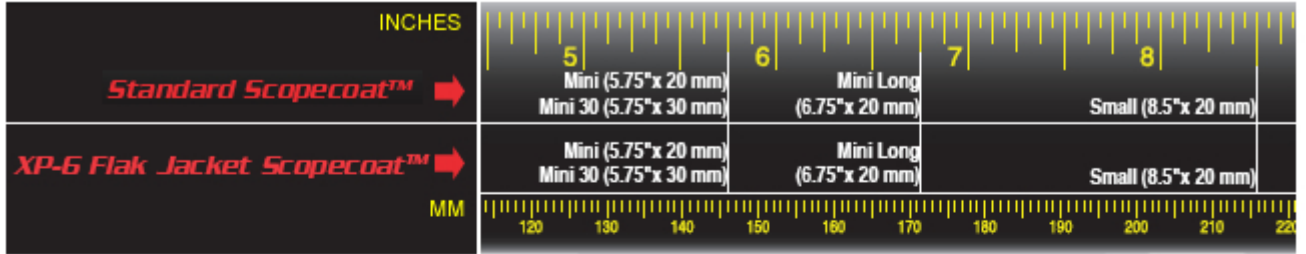
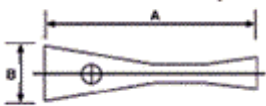

Scopecoats™ for General Cylinder Sized Optics

| Standard Cylinder Types | Material Thicknesses Available | Length (Stretch +/-10%) [A] | Objective End [B] |
|-------------------------|--------------------------------|-----------------------------|-------------------|
| Small                   | 6 mm                           | 8.0" / 20.3 cm              | 35 mm             |
| Medium                  | 6 mm                           | 10.5" / 26.7 cm             | 50 mm             |
| Large                   | 6 mm                           | 12.5" / 31.8 cm             | 42 mm             |
| Large 50                | 6 mm                           | 12.5" / 31.8 cm             | 50 mm             |
| Large 1452              | 6 mm                           | 14" / 35.6 cm               | 52 mm             |
| X-Large                 | 6 mm                           | 15.5" / 39.4 cm             | 60 mm             |
| XX-Large                | 6 mm                           | 17.5" / 44.4 cm             | 60 mm             |
| X-Large NF              | 6 mm                           | 19.5" / 49.5 cm             | 60 mm             |

Scopecoats™ for Specific Model Sized Devices

(Typically Not for Basic Cylinder Shaped Devices)

| Model Specific Types                          | Material Thicknesses Available |
|---|--------------------------------|
| ELCAN™  | 6 mm                           |
| ELCAN™ Specter DR                             | 6 mm                           |
| EOTECH 511/551                                | 6 mm                           |
| EOTECH 552/512                                | 2 & 3 mm                       |
| EOTECH 553                                    | 2 & 3 mm                       |
| Zeiss Diascope 65 & 85<br>Straight/Angled *** | 6 mm                           |